

Appendix A – Draft Official Plan Amendment

THE AMENDMENT

All of this part of the document titled “Details of the Amendment” consisting of the following text and map designated Schedule “A”, constitutes Amendment No. XX to the Official Plan for the City of Port Colborne.

DETAILS OF THE AMENDMENT

The Official Plan for the Port Colborne Planning Area is hereby amended as follows:

1. Notwithstanding section 3.2 of the Official Plan for the City of Port Colborne, low density residential uses may be permitted to a maximum net density of 30 units per hectare, medium density residential uses may be permitted to a maximum density of 95 units per hectare, and high density residential uses may be permitted to a maximum density of 150 units per hectare.

The following changes are made to Schedule A – City Wide Land Use of the Official Plan for the Port Colborne Planning Area:

1. That the area shown as “Urban Residential” and “EPA” and entitled “Schedule A to Official Plan Amendment No. XX”, shall be subject to Special Policy Area provisions and shall be identified on Schedule A City Wide Land Use Map of the Official Plan for the Port Colborne Planning Area.

IMPLEMENTATION AND INTERPRETATION

The implementation and interpretation of this amendment shall be in accordance with the respective policies of the Port Colborne Official Plan and an amendment to the City Zoning By-law to rezone the subject lands.

SCHEDULE A TO OFFICIAL PLAN AMENDMENT

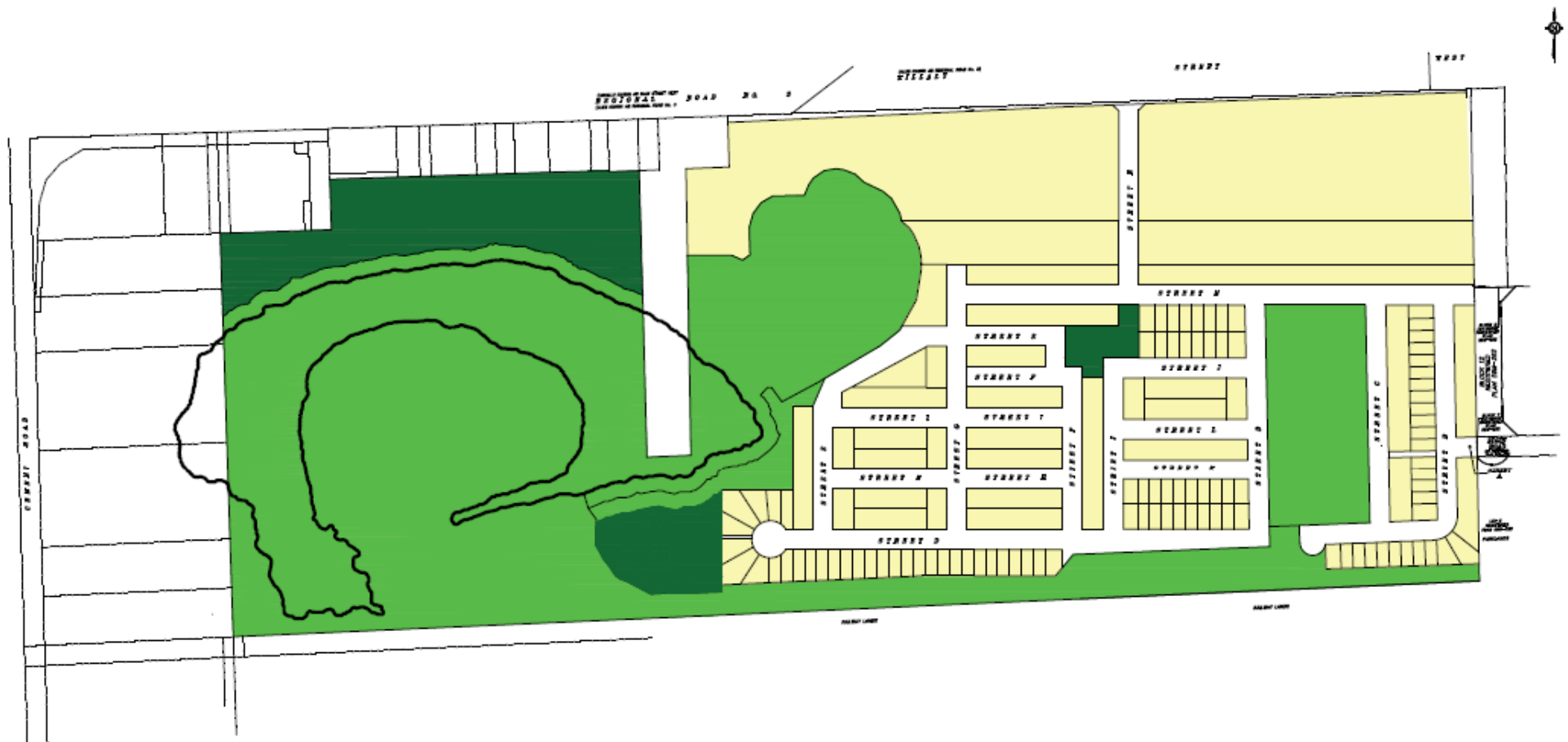

- Urban Residential
- Parks and Open Space
- Environmental Protection Area