

SURVEYOR'S SEAL

SKETCH

THIS IS AN ORIGINAL COPY IF EMBOSSED BY THE SURVEYOR'S SEAL OR PDF CERTIFIED

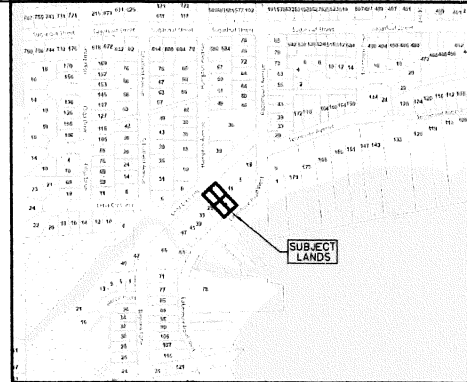

KEY PLAN (NOT TO SCALE)

SKETCH FOR SEVERANCE APPLICATION
AT No. 19 LAKESHORE ROAD
CITY OF PORT COLBORNE
REGIONAL MUNICIPALITY OF NIAGARA

0 5 10 15 20 m
SCALE 1 : 200



PROPERTY DESCRIPTION

LOTS 5 AND 6
REGISTERED PLAN 803
CITY OF PORT COLBORNE
REGIONAL MUNICIPALITY OF NIAGARA
ALL OF PIN 64403-0389(LT)

CAUTION

1. THIS IS NOT A PLAN OF SURVEY AND SHALL NOT BE USED EXCEPT FOR THE PURPOSES INDICATED IN THE TITLE BLOCK.
2. THIS SKETCH IS PROTECTED BY COPYRIGHT ©
3. THIS IS NOT AN ORIGINAL COPY UNLESS EMBOSSED WITH THE SURVEYOR'S SEAL, OR PDF CERTIFIED.

BOUNDARY NOTE

BOUNDARY INFORMATION HAS BEEN DERIVED FROM PLAN 59R-12844, REGISTERED PLAN 803, AND ACTUAL FIELD WORK.

LEGEND & NOTES

- C-L DENOTES CENTRELINE
- HP DENOTES HYDRO/UTILITY POLE
- OUL DENOTES OVERHEAD UTILITY/HYDRO LINE
- HM DENOTES HYDRO METER
- GM DENOTES GAS METER
- WV DENOTES WATER VALVE
- FH DENOTES FIRE HYDRANT
- AC DENOTES AIR CONDITIONER
- CS DENOTES CURB STOP
- MH DENOTES MANHOLE
- CLF DENOTES CHAIN LINK FENCE
- PED DENOTES COMMUNICATION PEDESTAL
- Ø DENOTES DIAMETER
- ⊗ DENOTES CONIFEROUS TREE (TREE CANOPY NOT TO SCALE)
- DENOTES DECIDUOUS TREE (TREE CANOPY NOT TO SCALE)

N-NORTH; S-SOUTH; W-WEST; E-EAST

FIELD WORK COMPLETED: FEBRUARY 27, 2023.

FEBRUARY 28, 2023
DATE

Harold D. Hyde
HAROLD D. HYDE
ONTARIO LAND SURVEYOR

© COPYRIGHT Rasch & Hyde Ltd., OLS, 2023.

RASCH + HYDE LTD.
Ontario Land Surveyors

P.O. Box 6, 1333 Highway #3 East, Unit B
DUNNVILLE, ONT, M1A 2M1
905-774-7188
(FAX 905-774-4000)

P.O. Box 550, 74 Jarvis Street
FORT ERIE, ONT, L2A 5Y1
905-871-9757
(FAX 905-871-9748)

HAROLD D. HYDE O.L.S.

SCALE 1 : 200 | SURVEY : 22F133 SEV SKETCH | DRWN BY : J.H.

METRIC NOTE

DISTANCES SHOWN ON THIS PLAN ARE IN METRES AND CAN BE CONVERTED TO FEET BY DIVIDING BY 0.3048

