

Easement Number	Easement Purpose	Applicable Parts on 5. Easement Plan (Proposed)
Easement 1	BMI Group to allow private sanitary pump station, access to pumping station for maintenance and repair of servicing within BMI remnant lands	Part 6, Part 7
Easement 2	BMI Group to allow for utility easements on BMI remnant lands	Part 5, Part 6, Part 8, Part 9
Easement 3	BMI Group is responsible for new road alignment for future road and to allow access easement, until such time that such lands are dedicated, conveyed, opened or otherwise established as a public highway	Part 9
Easement 4	BMI Group to allow servicing easement and swm pond to outlet to existing watercourse.	Part 5, Part 6, Part 8, Part of Part 9
Easement 5	BMI Group to retain access easement until such time that such lands are dedicated, conveyed, opened or otherwise established as a public highway and to allow for utility easements.	Part 10
Easement 6	BMI Group to allow Sanitary, Stormwater Management, Utilities, electrical station/substation, and Access	Part 11

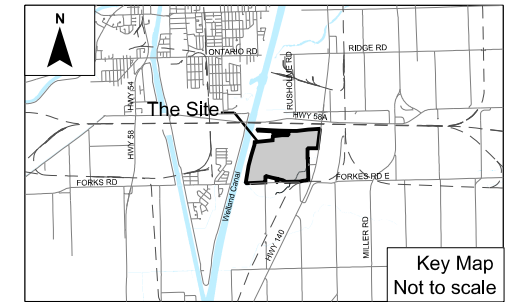
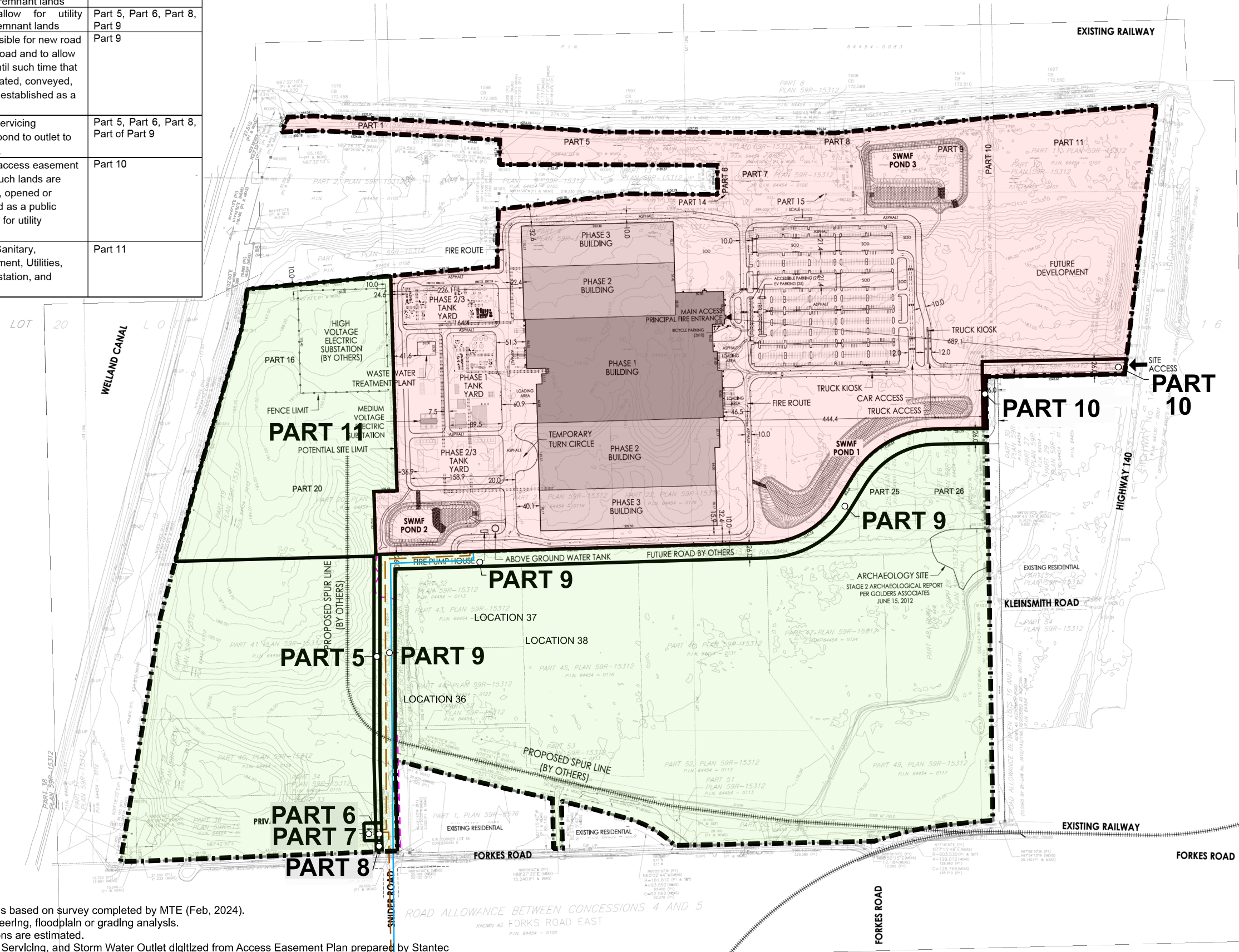

LEGEND

- Subject Lands
- MZO Area
- Estimated Sanitary Pipe Location
- Estimated Servicing Pipe Location
- Existing Water Course
- Proposed Easements (to be reg'st on BMI Lands)
- Lands to be Severed
- Lands to be Retained

DRAWN / REVISED

21 AUG 2024	Add Easement Table & modify Title block
19 AUG 2024	Revisions to Severed Area as per Client's comments
12-15 AUG 2024	Minor Revisions: Add Severance Info, Add Parts 29 and 30
08 AUG 2024	Remove adjacent property Easements
07 AUG 2024	Revise per Stantec Easement Consent Plan July 31, 2024
11 JUL 2024	Revise easements per comments
21 JUN 2024	First Draft

PROPOSED EASEMENT PLAN
HIGHWAY 58A & HIGHWAY 140
CITY OF PORT COLBORNE
REGION OF NIAGARA

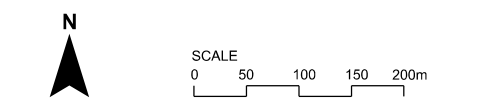

WESTON CONSULTING

File Number: 11746
Date: 2024-08-21
Drawn By: NDC/SM
Planner: MQ
CAD: 11746_Proposed Easement Plan_2024-08-21.dgn

Drawing
PEP

- Notes:
- Property Boundary is based on survey completed by MTE (Feb, 2024).
 - Not based on engineering, floodplain or grading analysis.
 - Areas and dimensions are estimated.
 - Estimates Sanitary, Servicing, and Storm Water Outlet digitized from Access Easement Plan prepared by Stantec and are approximate. See referenced plan for further details. Plan dated June 6, 2024.
 - Site Plan for Prepared by Stantec (June 18, 2024).
 - Proposed easements per Stantec Easement Consent Plan - Figure 1 (July 31, 2024)