

SKETCH PREPARED FOR SEVERANCE/MINOR VARIANCE APPLICATION

THIS IS NOT A PLAN OF SURVEY AND SHALL NOT BE USED FOR ANY PURPOSE OTHER THAN CURRENT SEVERANCE/MINOR VARIANCE APPLICATION. © THIS SKETCH IS PROTECTED BY COPYRIGHT.

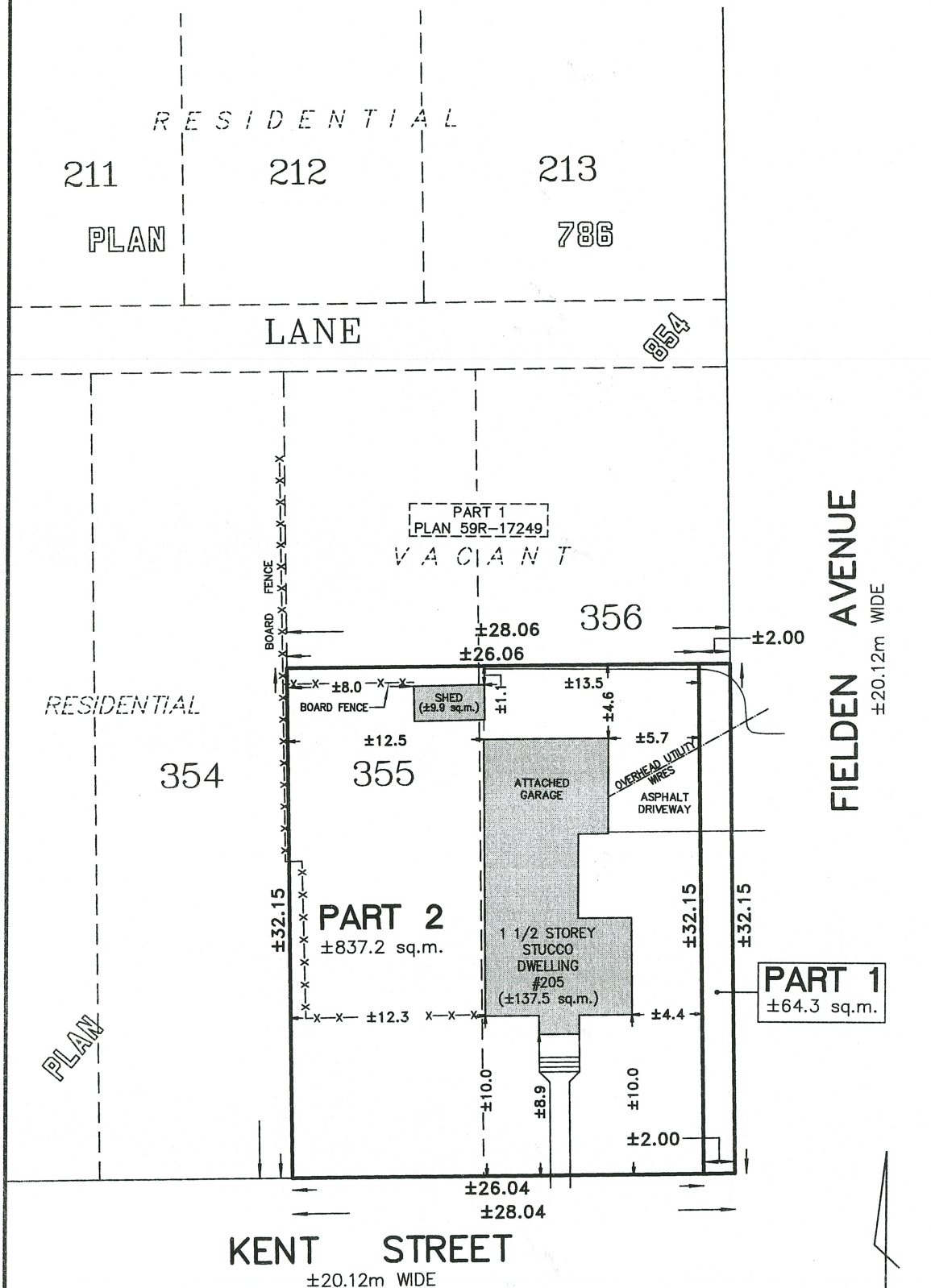

NOTE: THE PURPOSE OF PART 1 IS TO CREATE AN EASEMENT TO ALLOW FOR THE SERVICING OF THE PREVIOUSLY SEVERED LOT (PART 1 PLAN 59R-17249)

**VOID**

IF USED FOR ANY OTHER PURPOSE THAN THIS CURRENT CONSENT APPLICATION

PRELIMINARY ONLY

NOV. 12, 2025  
DATE

MARK GILMORE  
Ontario Land Surveyor

LANTHIER & GILMORE SURVEYING LTD.  
173 CLARENCE ST. PORT COLBORNE, ONT. (905) 835-5477

SKETCH OF PROPOSED SEVERANCE/MINOR VARIANCE

LOTS 355 & 356

PLAN 854

IN THE

CITY OF PORT COLBORNE  
REGIONAL MUNICIPALITY OF NIAGARA

DRAWN BY: CM

CHECKED BY: MG

SCALE: 1:300

SURVEY 22-549